

# CAPTOPRIL-REACH

## Consumer Medicine Information (CMI) summary

The [full CMI](#) on the next page has more details. If you are worried about using this medicine, speak to your doctor or pharmacist.

### Why am I using Captopril-Reach?

CAPTOPRIL-REACH contains the active ingredient Captopril. CAPTOPRIL-REACH is used to treat high blood pressure (hypertension), certain heart conditions, and certain kidney conditions associated with diabetes.

For more information, see Section [1. Why am I using CAPTOPRIL-REACH?](#) in the full CMI.

### What should I know before I take CAPTOPRIL-REACH?

Do not use if you have ever had an allergic reaction to captopril or any of the ingredients listed at the end of the CMI.

Do not use if you have diabetes or impaired kidney function or liver disease.

**Talk to your doctor if you have any other medical conditions, take any other medicines, or are pregnant or plan to become pregnant or are breastfeeding.**

For more information, see Section [2. What should I know before I take CAPTOPRIL-REACH?](#) in the full CMI.

### What if I am take other medicines?

Some medicines may interfere with CAPTOPRIL-REACH and affect how it works.

A list of these medicines is in Section [3. What if I am taking other medicines?](#) in the full CMI.

### How do I take CAPTOPRIL-REACH?

CAPTOPRIL-REACH is usually taken at a dose of 12.5 to 50mg (2.5 – 10ml) two or three times per day. Treatment may be started with low doses of CAPTOPRIL-REACH, particularly if you have heart failure. Your doctor will decide which dose is right for you.

Your doctor or pharmacist will show you how to administer this medicine by dosing cup or syringe. More instructions can be found in Section [4. How do I take CAPTOPRIL-REACH?](#) in the full CMI.

### What should I know while taking CAPTOPRIL-REACH?

<b>Things you should do</b>	<ul style="list-style-type: none"><li>• Remind any doctor, dentist or pharmacist you visit that you are using CAPTOPRIL-REACH.</li><li>• Have your blood pressure checked when your doctor tells you to check.</li><li>• Make sure you drink enough water during exercise and hot weather when you are taking it, especially if you sweat a lot</li></ul>
<b>Things you should not do</b>	Do not stop using this medicine suddenly.
<b>Driving or using machines</b>	Be careful before you drive or use any machines or tools until you know how CAPTOPRIL-REACH affects you.
<b>Drinking alcohol</b>	Alcohol may worsen dizziness or light-headedness.
<b>Looking after your medicine</b>	Keep CAPTOPRIL-REACH Oral Solution below 25°C. Discard 21 days after first opening. Keep this medicine out of the sight and reach of children.

For more information, see Section [5. What should I know while taking CAPTOPRIL-REACH?](#) in the full CMI.

### Are there any side effects?

All medicines can have side effects. If you do experience any side effects, most of them are minor and temporary

- Some common side effects are: lightheadedness, dizziness, headache, tiredness; dry cough; dry mouth; feeling sick; diarrhoea or constipation; stomach pains; taste disturbances; sleep disorders; hair loss; itching or a red rash; muscle cramps.
- very serious side effects that may need urgent medical attention or hospitalization include swollen face, lips, mouth, tongue, throat, hands, or feet; if you faint or if your skin and/or eyes turns yellow; sore throat and fever; chest pain; severe dizziness and fainting; difficulty breathing or swallowing; itchy skin and/or a rash; not urinating (passing water) as much as usual. Ulcers, blistering and skin rashes or burning, red, peeling skin on the lips, tongue and genitals, sometimes spreading to the eyes, face and body, (a very rare illness known as Stevens-Johnson syndrome)

# CAPTOPRIL-REACH

Active ingredient(s): *captopril*

## Consumer Medicine Information (CMI)

This leaflet provides important information about using CAPTOPRIL-REACH. **You should also speak to your doctor or pharmacist if you would like further information or if you have any concerns or questions about using CAPTOPRIL-REACH.**

Where to find information in this leaflet:

1. [Why am I using CAPTOPRIL-REACH?](#)

2. [What should I know before I take CAPTOPRIL-REACH?](#)

3. [What if I am taking other medicines?](#)

4. [How do I take CAPTOPRIL-REACH?](#)

5. [What should I know while taking CAPTOPRIL-REACH?](#)

6. [Are there any side effects?](#)

7. [Product details](#)

## 1. Why am I using CAPTOPRIL-REACH?

CAPTOPRIL-REACH contains the active ingredient **captopril**. Captopril belongs to a class of medicines known as Angiotensin Converting Enzyme (ACE) inhibitors. ACE inhibitors work to lower your blood pressure to normal levels if it is too high. CAPTOPRIL-REACH also acts to help your heart or kidneys to work better. Your doctor will tell you why you need to take CAPTOPRIL-REACH. Never let anyone else take your medicine. It may harm them, even if their signs of illness are the same as yours.

CAPTOPRIL-REACH is used for treating high blood pressure (hypertension), certain heart conditions, and certain kidney conditions associated with diabetes. These are long term (chronic diseases) so it is important that you continue to take your CAPTOPRIL-REACH every day.

There is no evidence that it is addictive or habit forming.

This medicine is only available only with a doctor's prescription.

## 2. What should I know before I take CAPTOPRIL-REACH

### Warnings

**Do not use CAPTOPRIL-REACH if:**

- you are allergic to captopril, or any of the ingredients listed at the end of this leaflet, or to another ACE inhibitor.

- if you are pregnant or think you may be pregnant,
- if you are breast-feeding.
- conditions known as idiopathic angioedema or hereditary angioedema
- you have diabetes or impaired kidney function and you are treated with a blood pressure lowering medicine containing aliskiren
- you have taken or are currently taking sacubitril/valsartan, a medicine used to treat a type of long-term (chronic) heart failure in adults, as the risk of angioedema (rapid swelling under the skin in an area such as the throat) is increased.

If any of the above applies to you, you should ask your doctor's advice before taking this medicine.

Symptoms of an allergic reaction to CAPTOPRIL-REACH may include

- shortness of breath, wheezing or difficulty breathing
- swelling of the face, lips, mouth, tongue or throat which may cause difficulty breathing or swelling of any other parts of the body
- rash, itching or hives on the skin

**Check with your doctor if you:**

- have any other medical problems, particularly diabetes, systemic lupus erythematosus, scleroderma, neutropenia (low white blood cell count), have had a heart attack, heart failure, ischaemic heart disease or cerebrovascular disease
- are taking any other medicines or drugs, including any immunosuppressant medicine
- have had an allergy to CAPTOPRIL-REACH or any of its additives, or to another ACE inhibitor
- have kidney disease, a single kidney or are undergoing dialysis
- have liver disease now or in the past
- are dehydrated, have had a recent bout of vomiting or diarrhoea or are taking a diuretic medicine (water tablets)

During treatment, you may be at risk of developing certain side effects. It is important you understand these risks and how to monitor for them. See additional information under Section [6. Are there any side effects?](#)

### Pregnancy and breastfeeding

Check with your doctor if you are pregnant or intend to become pregnant.

Talk to your doctor if you are breastfeeding or intend to breastfeed.

### Use in children

CAPTOPRIL-REACH is not recommended for use in children as there have been not enough studies of its effects in children. However it may be necessary for a child with hypertension and kidney problems to take this medicine, if this is the case your doctor will discuss all the possible risks and benefits to the child before starting therapy.

### 3. What if I am taking other medicines?

Tell your doctor or pharmacist if you are taking any other medicines, including any of the following medicines, vitamins or supplements that you buy without a prescription from your pharmacy, supermarket or health food shop:

- water tablets or diuretics (for example Lasix<sup>®</sup>, Urex<sup>®</sup>, Natrilix<sup>®</sup>, Moduretic<sup>®</sup>)
- lithium or lithium-containing preparations (for example Lithicarb<sup>®</sup>, Priadel<sup>®</sup>)
- potassium tablets (for example SPAN-K<sup>®</sup>, SLOW- K<sup>®</sup> or K-MAG<sup>®</sup>)
- potassium-containing salt substitutes (for example PRESSOR-K<sup>®</sup>)
- antacids
- any other medicine for high blood pressure
- any medicine for angina
- procainamide, a medicine for irregular heartbeat
- medicines for cancer treatment or in patients who had a transplantation (cytostatic agents/ immunosuppressant agents), such as fluorouracil, methotrexate, ciclosporin and azathioprine
- allopurinol, a medicine used to treat gout
- **if you are taking CAPTOPRIL-REACH for high blood pressure do not take any medicine (including ones bought without a prescription) for appetite control, asthma, colds, coughs, hay fever or sinus problems unless you have discussed the medicine with your doctor or pharmacist.**
- anti-inflammatory medicines (these are used to relieve pain, swelling and other symptoms of inflammation, including arthritis) and include nonsteroidal anti-inflammatory agents – NSAIDs (for example Voltaren, Indocid) and COX-2 inhibitors (for example Celebrex).

Taking a combination of CAPTOPRIL-REACH with a thiazide diuretic (fluid tablet) and an anti-inflammatory medicine may damage your kidneys.

Your doctor may need to change your dose and/or to take other precautions:

- If you are taking an angiotensin II receptor blocker (ARB) or aliskiren (see also "Do not use CAPTOPRIL-REACH if").

Your doctor will decide whether your treatment needs to be altered or whether you should have check ups or blood tests more frequently.

**Check with your doctor or pharmacist if you are not sure about what medicines, vitamins or supplements you are taking and if these affect CAPTOPRIL-REACH.**

### 4. How do I take CAPTOPRIL-REACH?

#### How much to take

CAPTOPRIL-REACH is usually taken at a dose of 12.5 to 50mg (2.5 – 10ml) two or three times per day. Treatment may be started with low doses of CAPTOPRIL-REACH, particularly if you have heart failure. Your doctor will decide which dose is right for you.

#### When to take it

Preferably take CAPTOPRIL-REACH one hour before meals.

#### How to take it

This medicine must be taken orally.

Your doctor or pharmacist will show you how to administer this medicine by dosing cup or syringe. The box containing this medicine will contain a 5ml dosing syringe, a syringe adaptor and a 30ml dosing cup.



5ml syringe, each numbered increment is 1ml equivalent to 5mg Captopril Oral Solution. The smaller increments are 0.2ml or 1mg of the solution.



30ml dosing cup, each numbered increment is 5ml equivalent to 25mg Captopril Oral Solution and having additional increments of 2.5ml (12.5mg) and 7.5ml (37.5mg).

Instructions are provided below for using the dosing syringe. If you have any questions about the dose you should use or how to use the syringe, ask your pharmacist.

- Open the bottle: press the cap and turn it anticlockwise (figure 1).
- Separate the adaptor from the syringe (figure 2). Insert the adaptor into the bottle neck (figure 3). Ensure it is properly fixed. Take the syringe and put

it in the adaptor opening (figure 4).

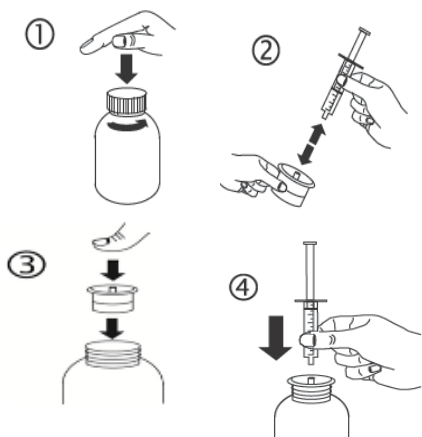

- c) Turn the bottle upside down. Fill the syringe with a small amount of solution by pulling the piston down (figure 5A), then push the piston upwards in order to remove any possible bubble (figure 5B). Pull the piston down to the graduation mark corresponding to the quantity in millilitres (ml) prescribed by your doctor (figure 5C).

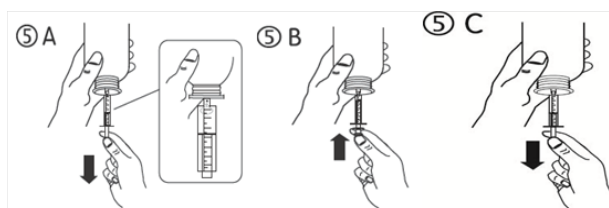

- d) Turn the bottle the right way up (figure 6A). Remove the syringe from the adaptor (figure 6B).

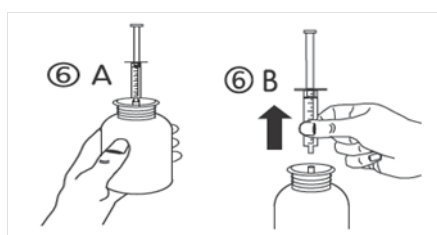

- e) Empty the contents of the syringe into the patient's mouth by gently pushing the piston to the bottom of the syringe (figure 7). The contents of the syringe should be emptied into the side cheek of the patient's mouth to avoid a choking hazard. Close the bottle with the plastic screw cap. Do not remove the syringe adaptor from the bottle. Wash the syringe with water (figure 8).

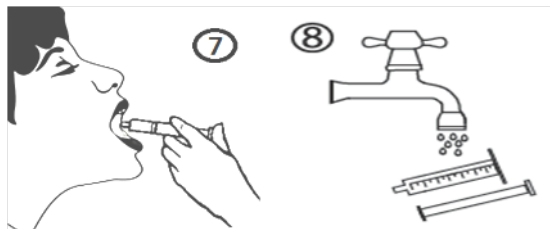

### ***If you forget to use CAPTOPRIL-REACH***

CAPTOPRIL-REACH should be used regularly at the same time each day. If you miss your dose at the usual time, take your next dose at the normal time and in the normal amount.

**If it is almost time for your next dose, skip the dose you missed and take your next dose when you are meant to.**

**Do not take a double dose to make up for the dose you missed.**

**Ask your doctor or pharmacist if you are not sure what to do.**

**If you have trouble remembering to take your medicine, ask your pharmacist for some hints.**

### ***If you use too much CAPTOPRIL-REACH***

If you think that you have used too much CAPTOPRIL-REACH, you may need urgent medical attention.

**You should immediately:**

- phone the Poisons Information Centre (**by calling 13 11 26**), or
- Contact your doctor, or
- go to Emergency Department at your nearest hospital.

**You should do this even if there are no signs of discomfort or poisoning.**

## **5. What should I know while taking CAPTOPRIL-REACH?**

### **Things you should do**

- **If you become pregnant while taking CAPTOPRIL-REACH tell your doctor immediately**
- **Have your blood pressure checked when your doctor tells you to, to make sure the medicine is working**
- **If you are about to start on any new medicine, tell your doctor and pharmacist that you are taking CAPTOPRIL-REACH.**
- **If you plan to have surgery (even at the dentist) that needs an anaesthetic, or are having some**

other hospital treatment, make sure that you tell your doctor or dentist that you are taking this medicine

- **Make sure you drink enough water during exercise and hot weather when you are taking it, especially if you sweat a lot**

If you do not drink enough water while taking CAPTOPRIL-REACH, you may faint or feel light-headed or sick. This is because your body does not have enough fluid and your blood pressure is low. If you continue to feel unwell, tell your doctor.

- **If you have excessive vomiting and/or diarrhoea while taking CAPTOPRIL-REACH, tell your doctor**

This can also mean that you are losing too much water and your blood pressure may become too low.

- **Have any blood tests that your doctor asks you to**

**Follow all directions given to you by your doctor carefully. They may differ from the information contained in this leaflet.**

If you do not understand the instructions on the box, ask your doctor or pharmacist for help.

### Things you should not do

- Do not stop using this medicine suddenly.

### Things to be careful of

CAPTOPRIL-REACH can cause dizziness, lightheadedness or fainting, especially when you get up from bed or from a chair.

**Always get up slowly to allow your body to adjust. Be careful the first time you take CAPTOPRIL-REACH.**

**If you are elderly, you should be particularly careful when you get up from bed or from a chair. If you are elderly, you should also be particularly careful when you are taking CAPTOPRIL-REACH for the first time.**

### Driving or using machines

**Be careful before you drive or use any machines or tools until you know how CAPTOPRIL-REACH affects you.**

As with other ACE inhibitors, CAPTOPRIL-REACH can cause dizziness or lightheadedness in some people, especially after the first dose. Make sure you know how CAPTOPRIL-REACH affects you before you drive a car or operate machinery, or do anything else that could be dangerous if you are dizzy or light-headed. If this occurs do not drive.

### Drinking alcohol

**Tell your doctor if you drink alcohol.**

Alcohol may worsen dizziness or light-headedness.

### Looking after your medicine

Keep this medicine out of the sight and reach of children.

A locked cupboard at least one- and-a-half metres above the ground is a good place to store medicines.

Keep CAPTOPRIL-REACH below 25°C.

### When to discard your medicine (as relevant)

Discard 21 days after first opening.

### Getting rid of any unwanted medicine

If you no longer need to use this medicine or it is out of date, take it to any pharmacy for safe disposal.

**Do not take CAPTOPRIL-REACH after the expiry date printed on the pack.** If you take CAPTOPRIL-REACH after this date or if CAPTOPRIL-REACH starts to change in appearance, colour or taste, it may not work as well.

## 6. Are there any side effects?

All medicines can have side effects. If you do experience any side effects, most of them are minor and temporary. However, some side effects may need medical attention.

See the information below and, if you need to, ask your doctor or pharmacist if you have any further questions about side effects.

**Tell your doctor or pharmacist if you notice any of the following and they worry you:**

- lightheadedness;
- dizziness;
- headache;
- tiredness;
- dry cough;
- dry mouth;
- feeling sick;
- diarrhoea or constipation;
- stomach pains;
- taste disturbances;
- sleep disorders;
- hair loss;
- itching or a red rash;
- muscle cramps.

If too much potassium builds up in your body you may experience the following:

- confusion;
- irregular heartbeat;
- nervousness;
- numbness or tingling of the hands, feet or lips;
- shortness of breath or difficulty breathing;
- weakness or heaviness of legs.

These are the more common side effects of CAPTOPRIL-REACH.

**You should stop taking CAPTOPRIL-REACH and call your doctor immediately or go to your nearest hospital if you get any of the following side effects:**

- swollen face, lips, mouth, tongue, throat, hands, or feet
- if you faint or if your skin and/or eyes turns yellow;
- sore throat and fever;
- chest pain;
- severe dizziness and fainting
- difficulty breathing or swallowing;
- itchy skin and/or a rash;
- not urinating (passing water) as much as usual.
- Ulcers, blistering and skin rashes or burning, red, peeling skin on the lips, tongue and genitals, sometimes spreading to the eyes, face and body, (a very rare illness known as Stevens-Johnson syndrome)

These are very serious side effects. You may need urgent medical attention or hospitalisation.

Other side effects not listed above may also occur in some patients.

**Tell your doctor or pharmacist if you notice anything that is making you feel unwell**

**Do not be alarmed by this list of possible side effects.** You may not experience any of them.

Other side effects not listed here may occur in some people.

### Reporting side effects

After you have received medical advice for any side effects you experience, you can report side effects to the Therapeutic Goods Administration online at [www.tga.gov.au/reporting-problems](http://www.tga.gov.au/reporting-problems). By reporting side effects, you can help provide more information on the safety of this medicine.

**Always make sure you speak to your doctor or pharmacist before you decide to stop taking any of your medicines.**

## 7. Product details

This medicine is only available with a doctor's prescription.

### What CAPTOPRIL-REACH contains

<b>Active ingredient (main ingredient)</b>	Captopril
<b>Other ingredients (inactive ingredients)</b>	sodium citrate (E331), citric acid monohydrate (E330), disodium edetate, sodium benzoate (E211) and purified water.
<b>Potential allergens</b>	Nil

**Do not take this medicine if you are allergic to any of these ingredients.**

### What CAPTOPRIL-REACH looks like

CAPTOPRIL-REACH is clear, colourless solution, flavour-free (AUST R 469565).

Each bottle contains 100mL oral solution in an amber glass bottle with tamper-evident child resistant plastic cap with a 5ml oral syringe with 0.2ml graduation marks and 30ml measuring cup with 5ml graduation marks and having additional graduation of 2.5ml and 7.5ml for measuring and administering the dose and a syringe adaptor.

### Who distributes CAPTOPRIL-REACH

Reach Pharmaceuticals Pty Ltd  
Ground Floor, Corporate One,  
84 Hotham Street,  
Preston VIC 3072

This leaflet was prepared in October 2025.